



moderntimes
HOTEL



moderntimes
HOTEL

YOUR HOTEL DEDICATED
TO CHARLIE CHAPLIN

○ Paris - FRANCE

Munich - GERMANY



AUSTRIA

LIECH.

St Moritz

Lugano

Milan - ITALY

Basel

Zürich

Luzerne

Bern

Titlis
Pilatus

Interlaken

Lausanne

Vevey
Montreux

Jungfrau

Glacier 3000

Geneva

Zermatt

Cervin
Matterhorn

IN THE HEART OF SWISS RIVIERA

BETWEEN LAKE GENEVA AND THE MOUNTAINS

You will love this 4* hotel situated near the famous Museum Chaplin's World by Grévin

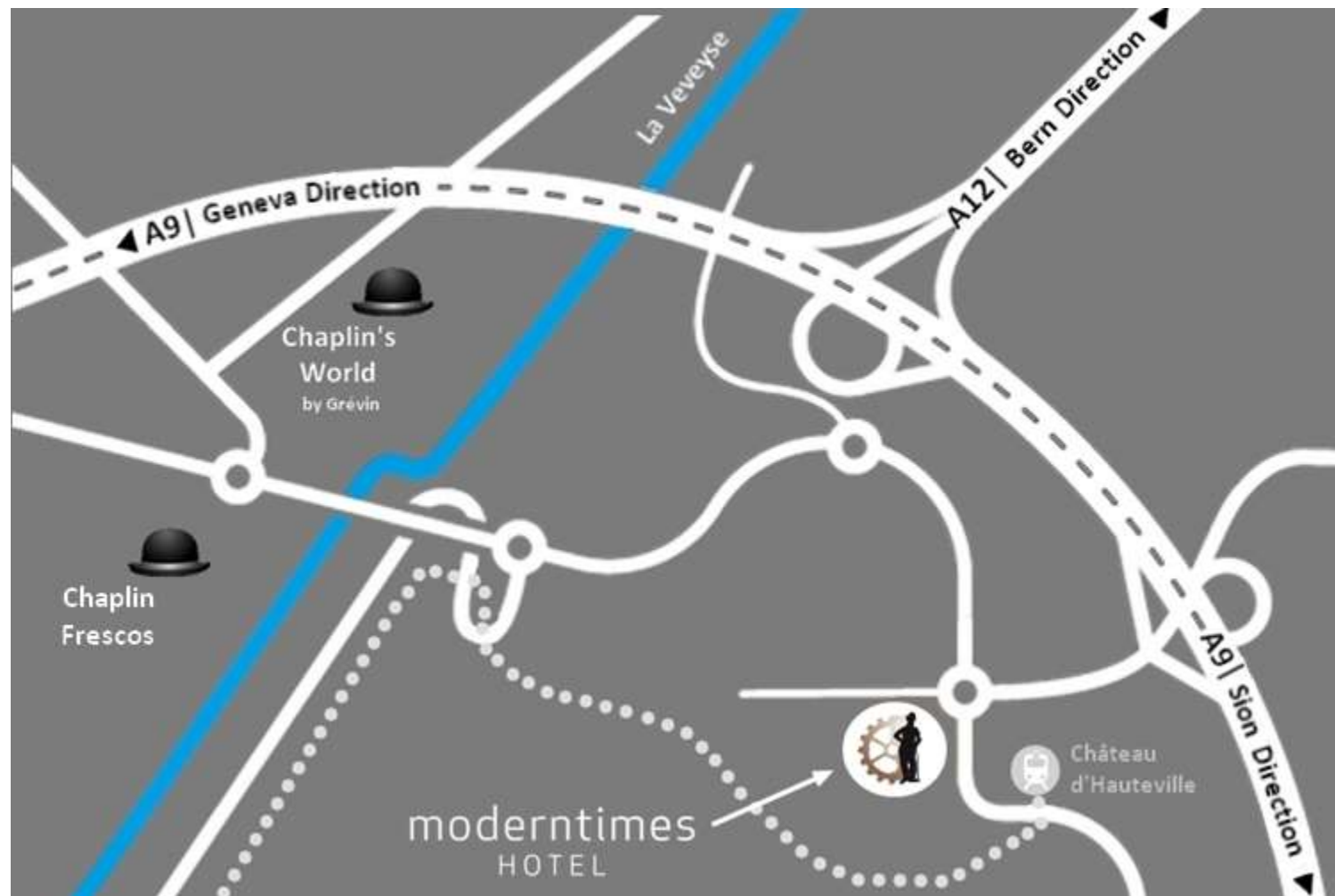



LAVAU, GENEVA LAKE, PLÉIADES

THE MOST BEAUTIFUL SWISS PANORAMAS

Lavaux, Unesco-listed vineyards terraces
surrounding the Lemane Lake



CHILLON CASTLE
10 minutes from the hotel



VEVEY, THE CITY OF IMAGE AND CULTURE
VEVEY, THE CITY OF CHARLIE CHAPLIN AND NESTLÉ

Near Montreux: Montreux Jazz Festival and Montreux Christmas Market

CLOSE TO
VEVEY

THE SWISS
RIVIERA





WELCOME !



MODERN TIMES HOTEL 4*

- . 136 rooms and contemporary Junior Suite
- . 1 restaurant – Times Grill
- . 1 lounge bar – Times Bar
- . 6 conference rooms (10 to 180 persons)
- . 1 fitness room
- . 120 private parking places





MODERN ROOM
24 sqm



MODERN ROOM
LAKE VIEW OR GARDEN VIEW | 24 sqm









MODERN SPACIOUS ROOM
36 sqm



MODERN JUNIOR SUITE
49 sqm



BREAKFAST BUFFET







A large portofolio of film-posters of Charlie Chaplin

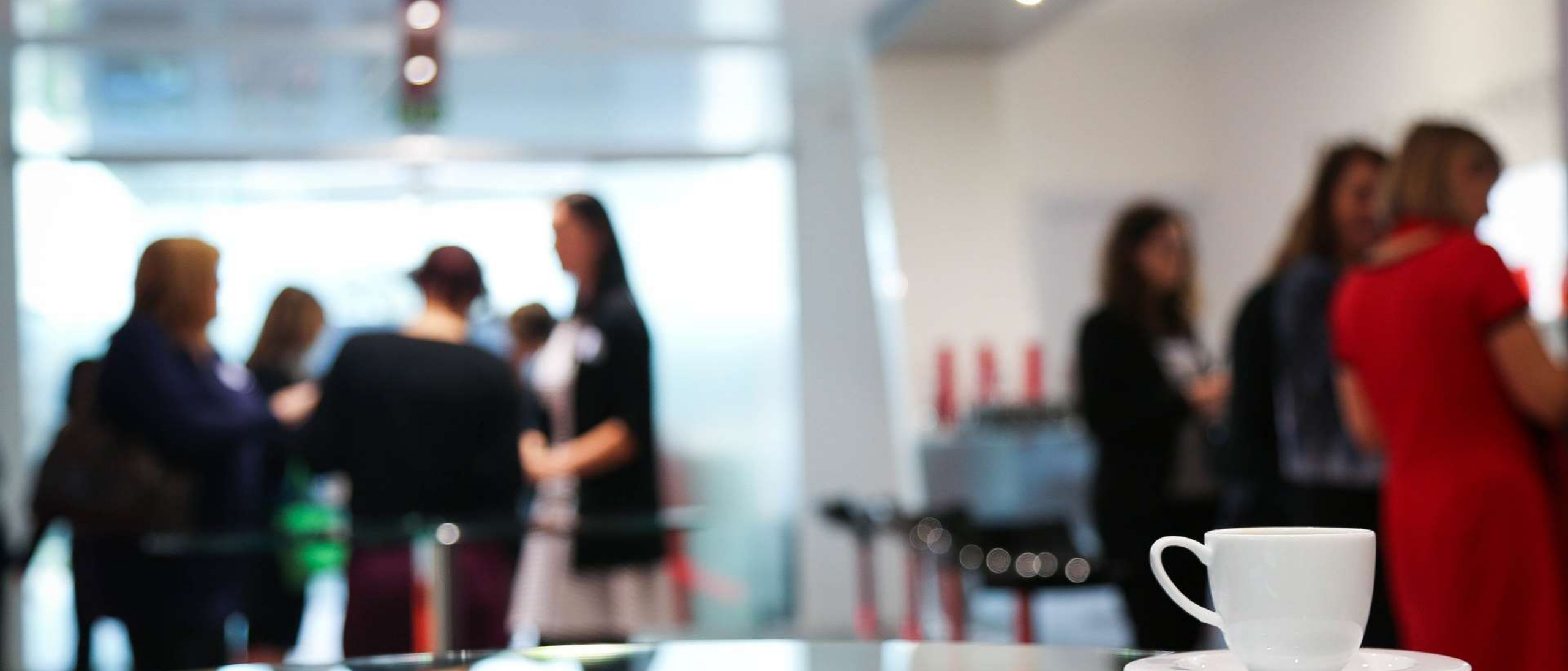



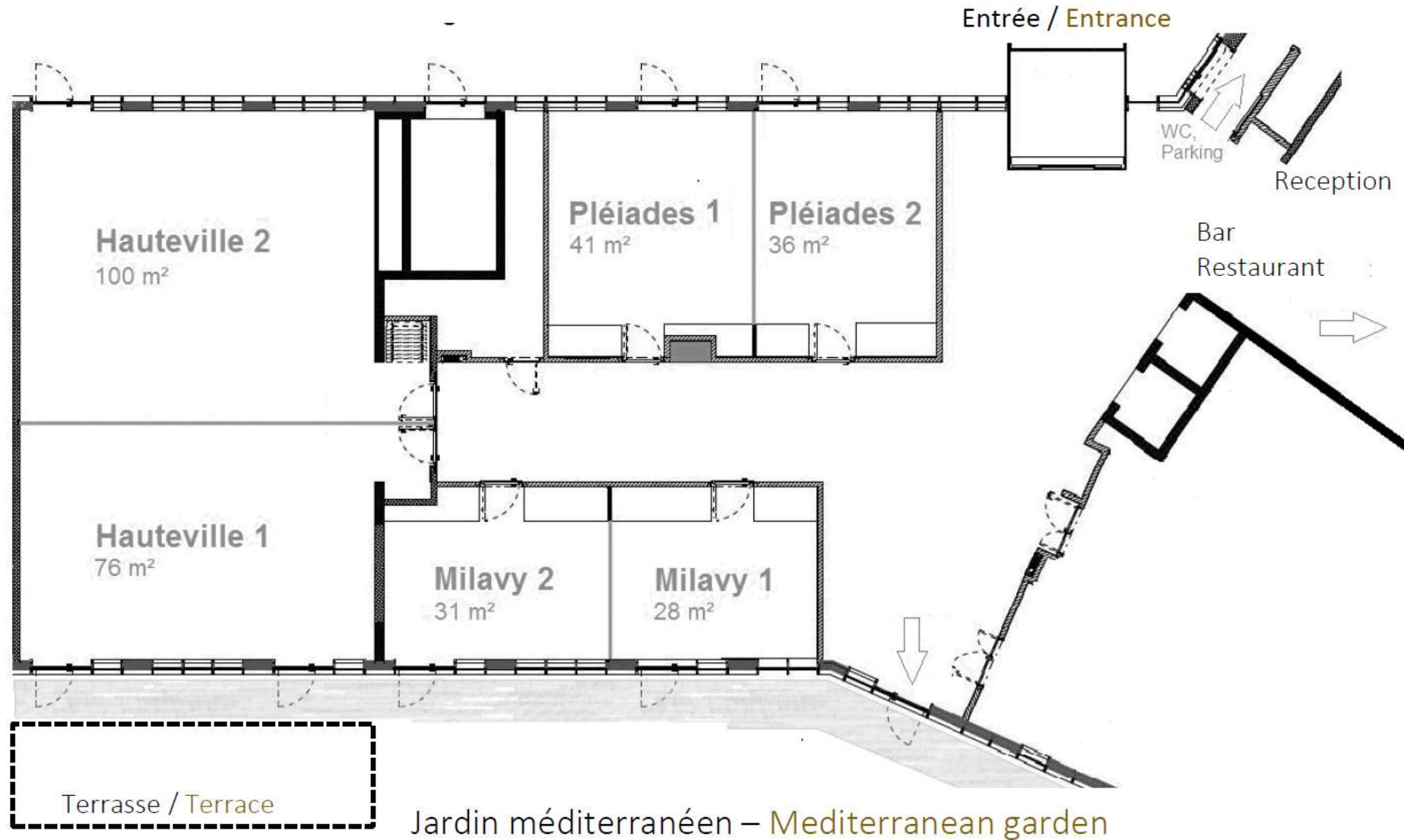

CONFERENCE AREA

Vue sur la montagne Les Pléiades – Mountain view Les Pléiades

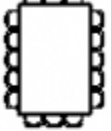
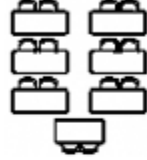
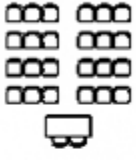

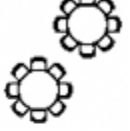
OUR MEETING ROOMS

Surface and capacity									Price in CHF		
Rooms	M ²	U-Shape	Boardroom	Classroom	Theater	Cabaret	Banquet	Cocktail	½ Day	Day	
Milavy	1	28	10	12	10	28	12	16	-	190.-	260.-
Milavy	2	31	10	12	10	28	12	16	-	200.-	280.-
Pléiades	1	41	14	16	18	40	24	32	-	220.-	310.-
Pléiades	2	36	10	12	10	28	18	24	-	260.-	350.-
Hauteville	1	76	24	28	30	50	30	40	70	320.-	420.-
Hauteville	2	100	30	36	40	70	42	56	100	420.-	550.-
Milavy	1+2	60	24	28	24	60	30	36	-	300.-	480.-
Pléiades	1+2	78	28	30	36	70	36	45	-	340.-	520.-
Hauteville	1+2	176	40	50	80	140	84	120	180	650.-	960.-
Salon VIP	1	40	15	18	18	40	24	32	40	200.-	300.-

Rates in CHF for seminars and conferences, except exhibitions

A modern conference room featuring a large, white, rectangular conference table with a black border. The table is surrounded by black office chairs with chrome frames. On the table, there are several water bottles and folders. The room has light-colored wood flooring and large windows with dark curtains. A black TV is mounted on the wall. In the background, there is a black sideboard with a coffee machine and a bowl of fruit.

MILAVY 1
28 sqm



MILAVY 2
31 sqm



HAUTEVILLE 1
76 sqm



HAUTEVILLE 1&2
176 sqm- MAX 180 PERSONS



HAUTEVILLE 1&2 BANQUET



timesgrill
MODERN TIMES HOTEL







TABLE D'HÔTES



SALON VIP



LOCAL PRODUCTS
SHOWGRILL CONCEPT







GARDEN TERRACE







APERITIF INSIDE OUR OLIVE TREES GARDEN





timesbar

MODERNTIMESHOTEL





MODERNTIMES bar









TEAMBUILDING



COOKING CLASS



WATCHMAKING

ESCAPE GAMES





THE REGION



CHAPLIN'S WORLD BY GREVIN MUSEUM

Embark on an extraordinary adventure across time and through the magical world of cinema. Prepare to be moved by one of the most surprising artists of the 20th century.

5 minutes from the hotel

www.chaplinsworld.com





PLÉIADES
Train nearby the hotel



GLACIER 3000
High level experience.

GLACIER 3000
1 hour from the hotel



MUSÉE NEST VEVEY
10 minutes from the hotel

OLYMPIC MUSEUM LAUSANNE
30 minutes from the hotel



CGN CRUISES – EVENT POSSIBLE ON BOARD





www.moderntimeshotel.ch

#moderntimeshotel

Tel:+41(0)21 925 22 22

info@moderntimeshotel.ch

